

## Accessories

### DIN Rail/Surface Mount Sockets

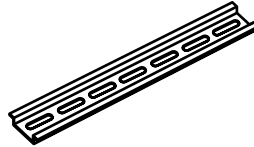
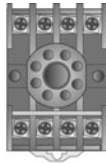

#### DIN Rail Mount Sockets

- 8 pin 600 V AC..... 12.2
- 8 pin 300 V AC..... 12.2
- 11 pin 300 V AC..... 12.2
- Hold Down Clips..... 12.2
- DIN Rail..... 12.3

#### Surface Mount Sockets

- 8 pin 600 V AC..... 12.3
- Hold Down Brackets ..... 12.3

### Mounting Methods, Terminals, Varistors, Cover and Marker



- Mini Mount/Standard Bracket ..... 12.4
- Front Panel Mount Kit..... 12.4
- DIN Rail Mount Adaptor ..... 12.4
- Back Panel Mount Adaptor ..... 12.4
- Heat Sink Compound ..... 12.4
- Quick Connect Screw Adaptor..... 12.5
- Female Quick Connect Terminals..... 12.5
- Metal Oxide Varistors ..... 12.5
- Sealable Transparent Cover ..... 12.5
- Marker Insert ..... 12.5

### Timer Adjustment Options & Dials



- Versa Pot ..... 12.6
- Q-Pot ..... 12.6
- Versa Knob ..... 12.6
- Lock Shaft ..... 12.6
- Mini Pot ..... 12.7
- Mini Knob ..... 12.7
- Time Adjustment Dials..... 12.7
- VTP/VTR..... 12.7

### Motor Protectors



- Three Phase Fuse Block/Disconnect .12.9
- Front Panel Mount Kit..... 12.9
- Voltage Reduction Module ..... 12.9

### Liquid Level Probes & Probe Holders



- Liquid Level Control Electrodes ..... 12.10
- Liquid Level Probe..... 12.10
- Suspension Electrode ..... 12.10
- Compact Probe Holder KH-3 ..... 12.11
- KH-3 Compact Probe Support..... 12.11
- Bar Electrodes ..... 12.11

### Current Transformers

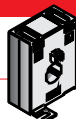

- Current Transformers..... 12.8

## Accessories Mounting Sockets

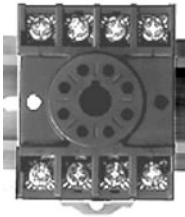

Approvals:

### DIN Rail or Surface Mount Sockets 8 Pin Octal Socket (600 VAC)

#### Description

8 pin 35 mm DIN rail or surface mount socket. OT08PC is rated at 10 A at 600 V AC and has pressure clamp terminals. For use with AWG 12 to 22 (3.2 to 0.33 mm<sup>2</sup>) wire sizes. Hold-down clips not available.

P/N: OT08PC

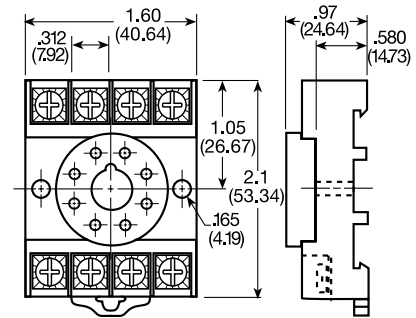

Inches (Millimeters)

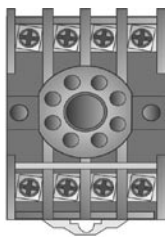

Approvals:

### 8 Pin Octal Socket (300 VAC)

#### Description

May be surface mounted with two #6 (M 3.5 x 0.6) screws or snaps onto a 35 mm DIN rail. A spring mechanism allows easy removal. Screw terminals with captive wire clamps accept up to two #14 AWG (2.45 mm<sup>2</sup>) wires. Rated 10 A at 300 V AC. Uses PSC8 hold-down clips.

P/N: NDS-8

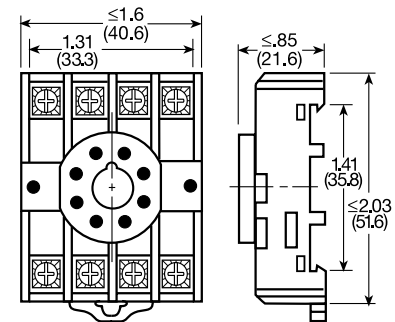

Inches (Millimeters)

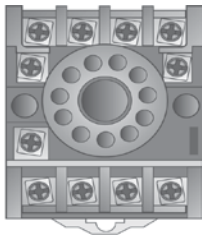

Approvals:

### 11 Pin Magnal Socket

#### Description

May be surface mounted with two #6 (M 3.5 x 0.6) screws or snaps onto a 35 mm DIN rail. A spring mechanism allows easy removal. Screw terminals with captive wire clamps accept up to two #14 AWG (2.45 mm<sup>2</sup>) wires. Rated 10 A at 300 V AC. Uses PSC11 hold-down clips.

P/N: NDS-11

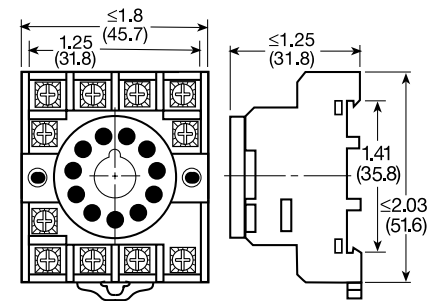

Inches (Millimeters)

### Hold-Down Clips

#### Description

Securely mounts plug in controls in any position. Also provides protection against vibration. Select the PSC8 for use with NDS-8 or the PSC11 for use with NDS-11 sockets. Comes in sets of two.

P/N: PSC8  
PSC11



# Accessories

## Mounting Sockets

S  
state  
relays

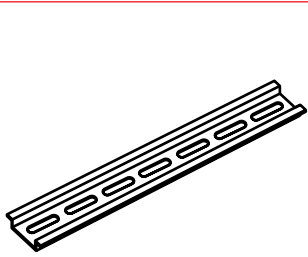

### DIN Rail

#### Description

Industry standard 35 mm aluminum or steel DIN rail. C103PM aluminum rail is available in 36 in. (91.4 cm) lengths. 017322005 zinc bichromate plated steel rail is available in 78 in. (2 m) lengths.

**P/N:** C103PM (Al)  
017322005 (Steel)

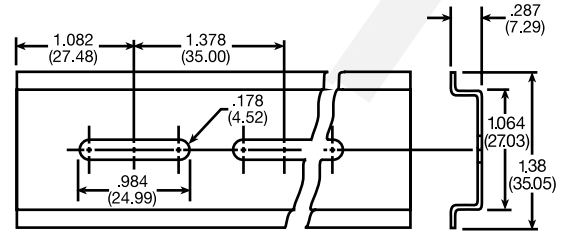

Inches (Millimeters)

C103PM Aluminum Rail  
(Prepunched cut out dimensions are approximate.)

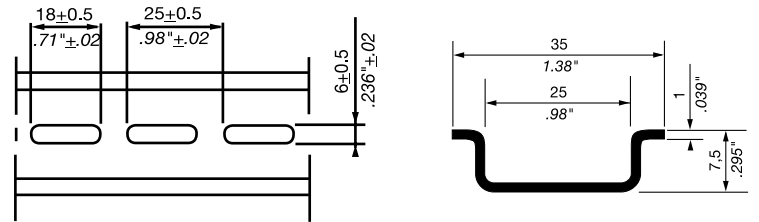

Inches (Millimeters)

017322005 Zinc Bichromate Plated Steel Rail  
(Prepunched cut out dimensions are approximate.)



Approvals:

### Surface Mount Sockets

#### 8 Pin Octal Socket (600 VAC)

#### Description

8 pin surface mount socket with binder head screw terminals. Rated 10 A at 600 V AC. When used with TDM, TDB, TDS Series timers the combination is UL Listed. Uses PSCRB8 hold-down brackets.

**P/N:** P1011-6

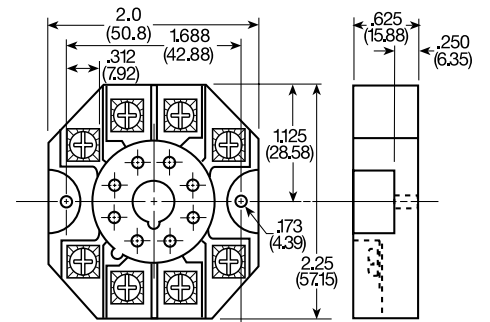

Inches (Millimeters)

### Hold-Down Brackets

#### Description

Designed for use with P1011-6 socket. Securely mounts 8 pin plug-in controls in any position, and provides protection against vibration. Comes in sets of two.

**P/N:** PSCRB8



MS002B01 06.09.05

# Accessories

## Mounting Methods, Terminals, Varistors, Cover and Marker



### Mini-Mount/Standard Mount Bracket

#### Description

Provides a convenient method of mounting 2 x 2 x 1.21 in. (50.8 x 50.8 x 30.7 mm) or 2 x 3 x 1.5 in. (50.8 x 76.2 x 38.1 mm) modules. The 90° orientation of mounting slots makes installation/removal of modules quick and easy. The P1023-6 secures to module with a #8 (M4 x 0.7) screw. The P1023-7 secures to 2 x 2 x 1.21 in. (50.8 x 50.8 x 30.7 mm) module with Mini-Pot for local adjustment. Made from steel with a cadmium surface finish.

Mounting Method	Mounting Hole Size	P/N
#8 (M4 x 0.7) screw	0.19 in. (4.8 mm)	P1023-6
Mini-Pot	0.25 in (6.35 mm)	P1023-7

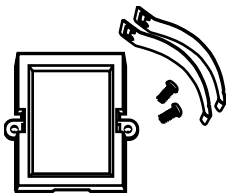
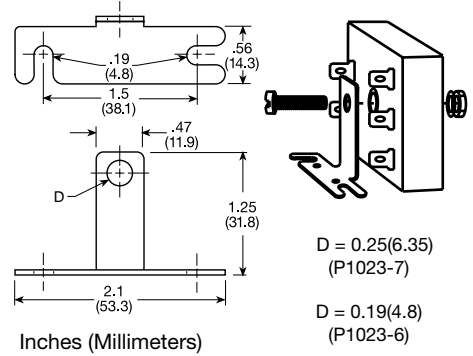

### Front Panel Mount Kit

#### Description

Provides an easy method of through-the-panel mounting of 8 or 11 pin plug-in timers, flashers, and other controls. May be mounted in panels up to 0.125 in. (3.2 mm) thick. Includes two clamps and two screws.

P/N: BZ1

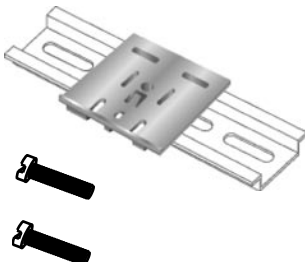
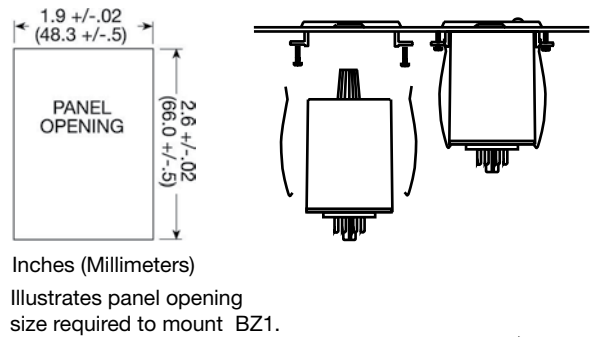

### DIN Rail Mount Adaptor

#### Description

Allows any 2 x 2 in. (50.8 x 50.8 mm) or 2 x 3 in. (50.8 x 76.2 mm) module to be mounted on a 35 mm DIN type rail. Comes complete with mounting hardware for 0.75 in. (19 mm) and 1 in. (25.4 mm) thick modules.

P/N: P1023-20

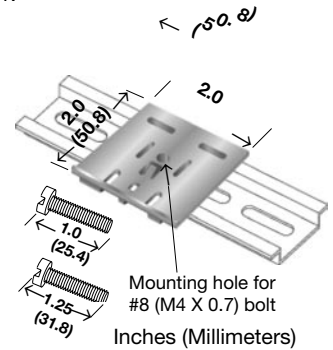

### Back Panel Mount Adaptor

#### Description

Provides a method for mounting 35 mm DIN 3 mounting timers and controls on the equipment's enclosure or back panel. Mount with two #6 (M3.5 x 0.6) screws.

P/N: 1SVR 430 029 R 0100

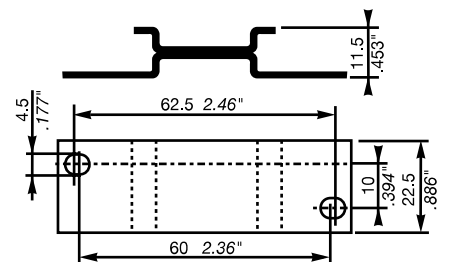

### Heat Sink Compound

#### Description

Bulk heat sink compound sufficient to mount over 50 high current, plated 2" x 2" (50.8 x 50.8 mm) timers or flashers. Contains approximately 100 grams.

P/N: P0200-20

## Accessories

### Mounting Methods, Terminals, Varistors, Cover and Marker

S  
state  
relays



### Quick Connect Screw Adaptor

#### Description

Screw adaptor terminal designed for use with all modules with 0.25 in. (6.35 mm) male quick connect terminals. Screw terminal accepts ring or spade terminals.

**P/N:** P1015-18



L = 0.55 (41.0)  
W = 0.32 (8.1)  
Inches (Millimeters)



### Female Quick Connect Terminals

#### Description

These 0.25 in. (6.35 mm) female terminals are constructed with an insulator barrel to provide strain relief.

Part Number	Wire Size
P1015-13	AWG 10/12 (5.3/3.2 mm <sup>2</sup> )
P1015-64	AWG 14/16 (2.5/1.3 mm <sup>2</sup> )
P1015-14	AWG 18/22 (0.93/0.33 mm <sup>2</sup> )



L = 0.83 (21.1)  
W = 0.3 (7.6)  
Inches (Millimeters)

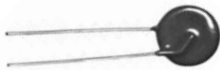

### Metal Oxide Varistors

P/N	Max. Operating Voltage		Max Impulse Current 80/20 us current wave (A)	Varistor Voltage at 1 mA DC Test Current		Peak Clamping Voltage with 80 us wave		Capacitance (pF)	Size (mm)
	DC (V)	AC (V)		Min.(V)	Max.(V)	Vc (V)	Ip (A)		
P1012-27	200	150	1200	212	268	395	10	150	7
P1012-25	200	150	4500	212	268	395	50	800	14
P1012-3	369	275	1200	389	515	775	10	85	7
P1012-6	369	275	4500	389	475	710	50	450	14



### Sealable Transparent Cover

#### Description

Protection against unauthorized adjustments of 22.5 mm and 45 mm IEC type timers and controls.

Part Number	Cover Size
1SVR 430 005 R 0100	22.5 mm
1SVR 440 005 R 0100	45 mm

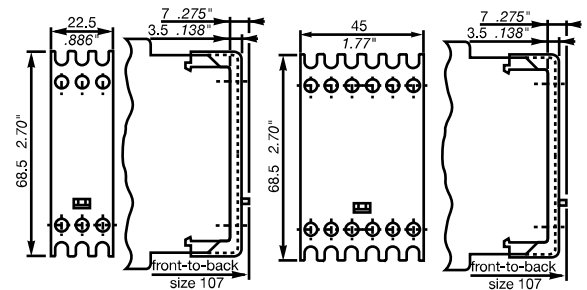

Cover for 22.5 mm

Cover for 45 mm



### Marker Insert

#### Description

Replacement unit marker insert for use with 22.5 mm and 45 mm IEC timers and controls that include replaceable markers.

**P/N:** 1SVR 366 017 R 0100

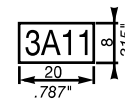

MS002E01 06.09.05

## Accessories

### Timer Adjustment Options and Dials



Approvals: cULus

#### Versa-Pot

##### Description

Panel mountable, industrial potentiometer recommended for remote time delay adjustment. The shaft is slotted for screwdriver adjustment and serrated for slip-proof finger adjustment. Accepts Versa-Knob or Lock Shaft. May be ordered with two 8 in. (20.3 cm) wires soldered to pot (clockwise increase) and female quick connect terminals on other ends by adding suffix -X to end of part number.

Versa Pot P/N	With Wire Leads	Value
P1004-198	P1004-198-X	25KΩ
P1004-199	P1004-199-X	50KΩ
P1004-95	P1004-95-X	100KΩ
P1004-17	P1004-17-X	500KΩ
P1004-16	P1004-16-X	1 MΩ
P1004-15	P1004-15-X	1.5 MΩ
P1004-14	P1004-14-X	2 MΩ
P1004-12	P1004-12-X	3 MΩ
P1004-13	P1004-13-X	5 MΩ

Specifications	
Rating	0.25W at 55°C
Taper	Linear
Shaft Rotation	300° +/-5°
Tolerance	+/-10%

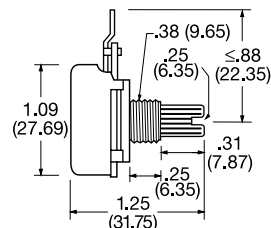

Inches (Millimeters)

#### Q-Pot

##### Description

A high quality cermet potentiometer for use when linearity and stability are important and when high temperature or harsh environments exist. Accepts Versa-Knob or Lock Shaft. May be ordered with two 8 in. (20.3 cm) wires soldered to pot (clockwise increase) and female quick connect terminals on other ends by adding suffix -X to end of part number.

P/N	With Wire Leads	Value
P1004-3	P1004-3-X	500KΩ
P1004-4	P1004-4-X	1 MΩ

Specifications	
Rating	2W at 70°C
Taper	Linear
Shaft Rotation	280° +/-5°
Tolerance	+/-10%

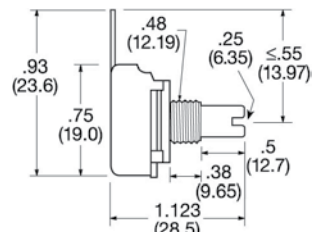

Inches (Millimeters)

#### Versa-Knob

##### Description

Versa-Knob is designed for 0.25 in. (6.35 mm) shaft of Versa-Pot or Q-Pot. Semi-Gloss industrial black finish.

P/N: P0700-7

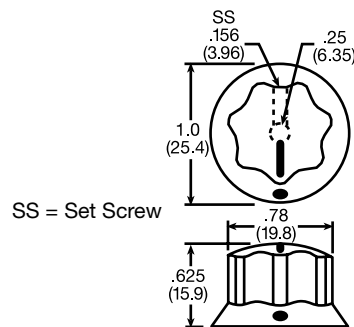

Inches (Millimeters)

#### Lock Shaft

##### Description

Fits 0.25 in. (6.35 mm) potentiometer shafts. Locks by tightening nut onto four tapered/slotted fingers. Pressure on the shaft locks control against mis-adjustment. Nickel plated brass finish.

P/N: P0700-8

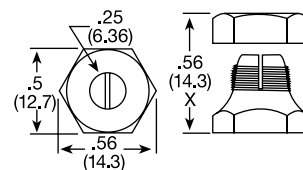

X = Locked on shaft  
Inches (Millimeters)

# Accessories

## Timer Adjustment Options and Dials



### Mini-Pot

#### Description

A high quality, industrial potentiometer for remote time delay adjustment. The shaft extends through the timer's center hole for easy panel mounting. Use mini-mount bracket for standup mounting of timer. Adjustment by screwdriver or mini-knob. May be ordered with two 3 in. (7.6 cm) wires soldered to pot (clockwise increase) and female quick connect terminals on other ends by adding suffix -X to end of part number.

P/N	With Wire Leads	Value
P1004-9	P1004-9-X	500KΩ
P1004-10	P1004-10-X	1 MΩ
P1004-31	P1004-31-X	3 MΩ

Specifications	
Rating	0.25W at 55°C
Taper	Linear
Shaft Rotation	300° +/-5°
Tolerance	+/-10%

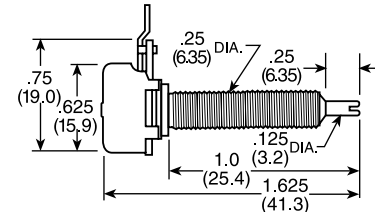

Inches (Millimeters)



### Mini-Knob

#### Description

Black plastic control knob with fluted body and white index/dot for setting accuracy. Mounts on 0.125 in. (3.2 mm) shaft of Mini-Pot.

P/N: P0700-21

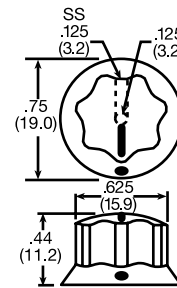

SS = Set Screw  
Inches (Millimeters)

### Time Adjustment Dials

#### Description

Dials for use with remote Versa-Pot and panel mounted Mini-Pot. Reverse screen printed on clear plastic to avoid damage to printed image.

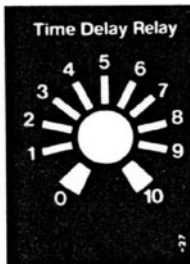

P/N	Range	Increments	P/N	Range	Increments
P0400-12	.05 ... 1s	0.1s	P0400-20	2 ... 180s	30s
P0400-13	.05 ... 2s	0.2s	P0400-21	0.1 ... 4m	0.5m
P0400-14	.05 ... 3s	0.5s	P0400-22	0.1 ... 5m	0.5m
P0400-15	0.1 ... 5s	0.5s	P0400-23	0.1 ... 6m	1m
P0400-82	0.1 ... 10s	1s	P0400-24	0.1 ... 7m	1m
P0400-17	1 ... 30s	5s	P0400-25	0.1 ... 8m	1m
P0400-83	1 ... 60s	10s	P0400-26	0.1 ... 10m	1m
P0400-19	2 ... 120s	20s	P0400-27	0...10	MRD*

\*Multiplier Reference Dial

### VTP/VTR

#### Description

The VTP Series mounts on modules with in-line adjustment terminals. Rated at 0.25W at 55°C. Available in resistance values from 5KΩ to 5MΩ.

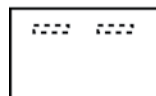

VTP  
Top View

### Ordering Table (select one from each column)

Series	R <sub>T</sub> Value	Range
<b>VTP</b>	<b>A</b> - 5KΩ	<b>A</b> - 0.05 ... 1 s
	<b>B</b> - 10KΩ	<b>B</b> - 0.05 ... 3 s
	<b>C</b> - 20KΩ	<b>C</b> - 0.1 ... 10 s
	<b>D</b> - 50KΩ	<b>D</b> - 0.5 ... 10 s
	<b>0</b> - 250KΩ	<b>E</b> - 0.5 ... 20 s
	<b>1</b> - 0.5 MΩ	<b>F</b> - 0.5 ... 60 s
	<b>2</b> - 1 MΩ	<b>G</b> - 1 ... 100 s
	<b>3</b> - 2 MΩ	<b>H</b> - 2 ... 120 s
	<b>4</b> - 3 MΩ	<b>J</b> - 2 ... 180 s
	<b>5</b> - 5 MΩ	<b>K</b> - 10 ... 1000 s
		<b>L</b> - 0.1 ... 4 m
		<b>M</b> - 0.1 ... 6 m
		<b>N</b> - 0.1 ... 10 m
		<b>P</b> - 1 ... 100 m
		<b>R</b> - 0 ... 10 MRD*
		<b>S</b> - 0.1 ... 8 m
		<b>T</b> - 0.1 ... 5 m
		<b>X</b> - All time range labels

Example P/N: **VTP4F**

\*Multiplier Reference Dial

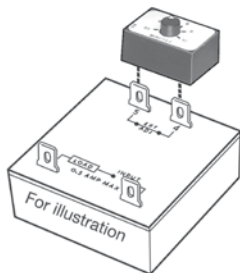

Approvals:

AC003B01 12/09/05

## Accessories

### Current Transformers CM-CT



CM-CT



CM-CT with mounted accessories



CM-CT-A  
DIN Rail Adaptor  
P/N 1SVR450118R1000

#### Current Transformers CM-CT

- Primary AC current from 50 A to 600 A in 9 ranges
- Secondary current from 0 to 1 A or 0 to 5 A
- Class 1 accuracy = +/- 1% of the measured value
- Use with or without mounting brackets and buss bar fastening screws
- Protected connection terminals with 2 screws for each secondary connection

#### Secondary Current 1 A

Type	Nominal/ primary current	Power/ Accuracy (%)	New Part Number	Center Dimension (mm)	Old Part Number
CM-CT 50/1	50 A	1 VA / 1	1SVR 450 116 R1000	20	E4 450 116 10
CM-CT 75/1	75 A	1.5 VA / 1	1SVR 450 116 R1100	20	E4 450 116 11
CM-CT 100/1	100 A	2.5 VA / 1	1SVR 450 116 R1200	20	E4 450 116 12
CM-CT 150/1	150 A	2.5 VA / 1	1SVR 450 116 R1300	20	E4 450 116 13
CM-CT 200/1	200 A	2.5 VA / 1	1SVR 450 116 R1400		E4 450 116 14
CM-CT 300/1	300 A	5 VA / 1	1SVR 450 117 R1100	10 x 30	E4 450 117 11
CM-CT 400/1	400 A	5 VA / 1	1SVR 450 117 R1200	10 x 30	E4 450 117 12
CM-CT 500/1	500 A	5 VA / 1	1SVR 450 117 R1300	10 x 30	E4 450 117 13
CM-CT 600/1	600 A	5 VA / 1	1SVR 450 117 R1400	10 x 30	E4 450 117 14

#### Secondary Current 5 A

Type	Nominal/ primary current	Power/ Accuracy (%)	New Part Number	Center Dimension (mm)	Old Part Number
CM-CT 50/5	50 A	1 VA/1	1SVR 450 116 R5000	20	E4 450 116 50
CM-CT 75/5	75 A	1.5 VA/1	1SVR 450 116 R5100	20	E4 450 116 51
CM-CT 100/5	100 A	2.5 VA/1	1SVR 450 116 R5200	20	E4 450 116 52
CM-CT 150/5	150 A	2.5 VA/1	1SVR 450 116 R5300	20	E4 450 116 53
CM-CT 200/5	200 A	5 VA/1	1SVR 450 116 R5400	20	E4 450 116 54
CM-CT 300/5	300 A	5 VA/1	1SVR 450 117 R5100	10 x 30	E4 450 117 51
CM-CT 400/5	400 A	5 VA/1	1SVR 450 117 R5200	10 x 30	E4 450 117 52
CM-CT 500/5	500 A	5 VA/1	1SVR 450 117 R5300	10 x 30	E4 450 117 53
CM-CT 600/5	600 A	5 VA/1	1SVR 450 117 R5400	10 x 30	E4 450 117 54

#### Connection Diagrams

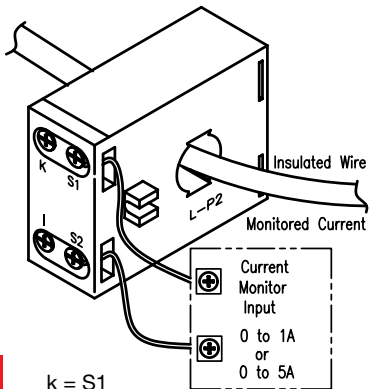

k = S1  
l = S2  
L - P2 = Phase Orientation  
K - P1 = Phase Orientation

**CM-CT**  
Connected to A current monitor with CT input connections

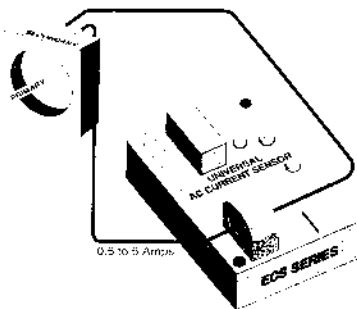

**CM-CT**  
Connection to a current monitor with built in torrid current transformer. A wire connected from S1 to S2 is passed through the toroidal sensor.

#### Mechanical View

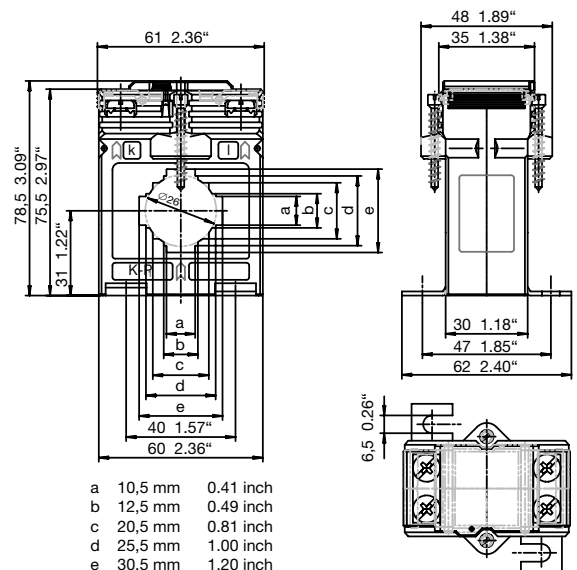



# Accessories

## Motor Protectors

S  
state  
relays

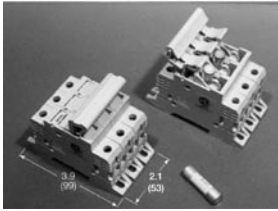

### Three Phase Fuse Block/Disconnect

#### Description

Three phase fuse block disconnect designed for use with HRC midjet fuses [1.5 x .41 in. (38.1 x 10.4 mm)] rated up to 25 A at 500 V AC. Surface or 35mm DIN rail mountable. 3.9 x 2.09 x 2.2 in. (99 x 53.1 x 55.9 mm)

#### Midget Fuse

Fast acting fuse for use with voltage monitors. Rated 2 A at 500 V AC. 1.5 x .41 in. (38.1 x 10.4 mm)

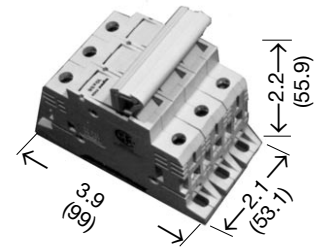

Part Number	Description
P0700-241	Fuse Block
P0600-11	Fuse

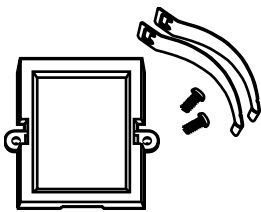

### Front Panel Mount Kit

#### Description

Provides an easy method of through-the-panel mounting of 1.78 x 2.39 in. (60.7 x 45.2 mm) 8 or 11 pin plug-in controls. May be mounted in panels up to 0.125 in. (3.2 mm) thick. Includes two clamps and two screws.

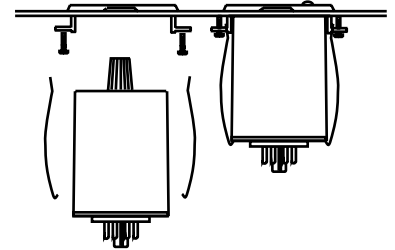
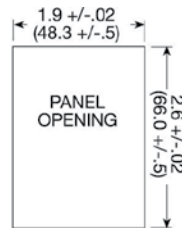

P/N: BZ1

Inches (Millimeters)

Illustrates panel opening size required to mount BZ1.

### Accessory Module

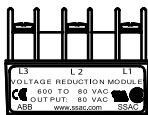

The VRM6048 Accessory Module allows the voltage monitor to monitor a 3-Phase 550 ... 600 V AC Line. The VRM can be used with voltage monitor series: TVM, TVW, PLM, PLR, and PLS manufactured after December 2003.

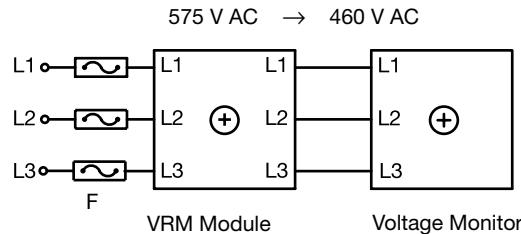

P/N: VRM6048

\* The VRM6048 must be connected as shown. If the voltage monitor is disconnected, the VRM output voltage equals the input voltage.

Adjustment: If the measured line voltage is 575 V AC, connect as shown and adjust/select the voltage monitor for 460 V AC operation.

Voltage:	INPUT	*OUTPUT
	600 V AC	480 V AC
	575 V AC	460 V AC
	550 V AC	440 V AC

- Package: Molded Housing with Encapsulated
- Circuitry
- Mounting: Surface Mount with One #10 (M5 x 0.8) Plastic Screw. May be DIN Rail Mounted Using P1023-20 Adaptor.
- Termination: Screw Terminals with Captive Wire Clamps for up to No.12 AWG Wire.

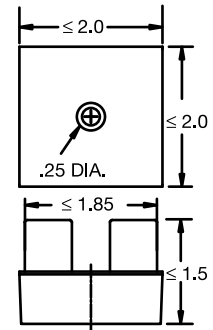

Inches (Millimeters)

F = 2 A Fast Acting Fuses are recommended but not required.

- Operating: -40°C to +70°C
- Storage: -40°C to +85°C
- Humidity: 95% Relative, Non-Condensing

MP001B01 02.22.05

## Accessories

### Liquid Level Probes and Probe Holders



#### Liquid Level Control Electrodes

##### Description

Designed for use with all conductive liquid level controls. Composed of an alumina insulator and metal parts made of number 300 series nonmagnetic stainless steel. These internally conductive glass-sealed electrodes are capable of up to 2,500 PSI (172.4 bars) at 21°C and 371°C at 1 atmosphere.

Part Number	Description
WCC-1138	Electrode (UL Recognized)
WCC-1138-3	Electrode with Common Connection

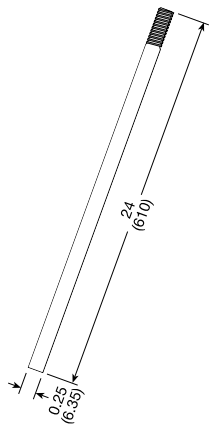
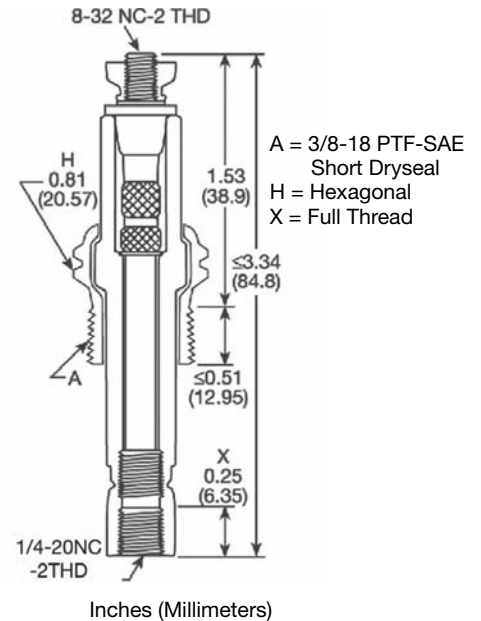

Inches (Millimeters)

#### Liquid Level Probe

##### Description

Threaded stainless steel probe measuring 24 in. (61 cm) long. Designed for use with WCC-1138 and WCC-1138-3 liquid level control electrodes.

P/N: LLP-24



#### Suspension Electrode

##### Description

Steel electrode (X 12 CR Mo S 17) with sleeve (Lupulen 6011 L) suitable up to 60°C max. Attaches to an insulated wire suspended from the top of the holding tank. Length of wire determines the sensing location.

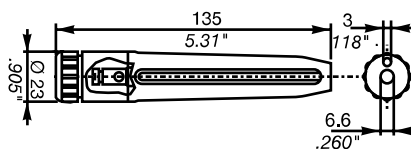

Part Number	Pack. unit (pieces)	Weight 1 pc. kg/oz
1SVR 402 902 R 0000	1	0.053/1.855

# Accessories

## Liquid Level Probes and Probe Holders

Compact Support KH-3

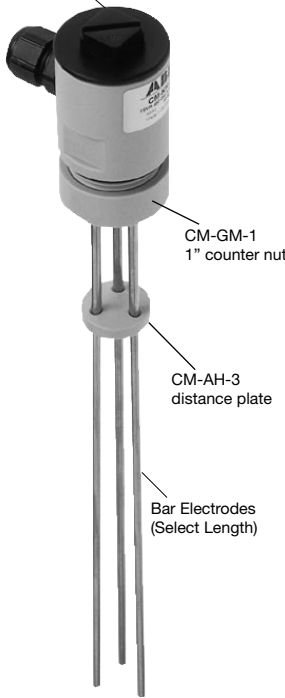

### Compact Probe Holder KH-3 for 3 bar electrodes

- Ideally suited for use with liquid level relays
- Wire connection by screw terminals
- Strain relief by M16 cable gland
- Temperature range up to 90 °C
- Food safe material (PPH)
- Screw-in electrodes (M4 thread)
- Distance plate (AH-3) and locking nut (GM-1) optionally available as accessories

### KH-3 Compact Probe Support

#### Description

Type of mounting: G 1" thread  
 Mounting position: any  
 Enclosure material: PPH  
 Sealing: NBR 70  
 Temperature range: 90 °C max.  
 Pressure: 10 bar max. (60 °C)

Compact support KH-3

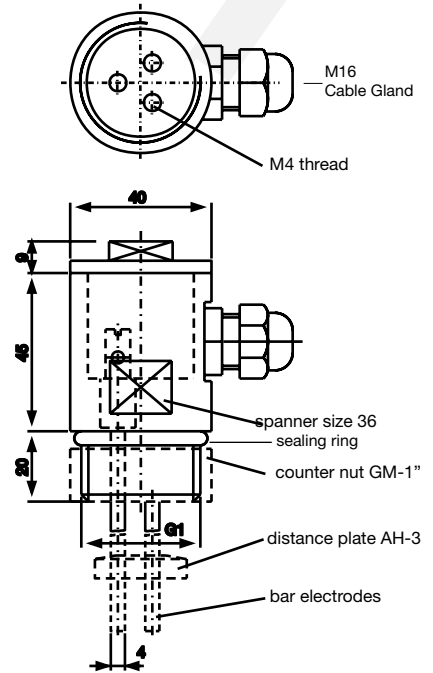

#### Accessories

**Distance Plate AH-3**  
 Use optional distance plate AH-3 to keep long probes from touching.

**Counter Nut GM-1**  
 Use optional counter nut GM-1 for tanks that cannot be threaded.

Optional Distance plate AH-3

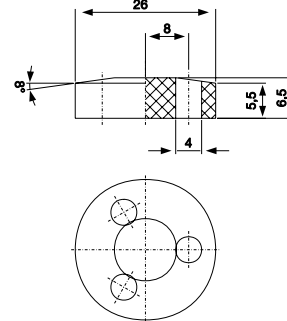

Optional Counter nut GM-1  
 G1 = 1 in (25.4 mm)

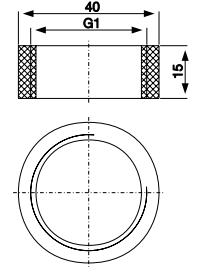

\*Dimensions in Millimeters

Type	Description	Part Number	Pack. unit (pieces)	Weight 1 piece kg/oz
CM-KH-3	Compact support for 3 bar electrodes	1SVR 450 056 R 6000	1	0.085/3.000
CM-AH-3	Distance plate for 3 bar electrodes	1SVR 450 056 R 7000	1	0.004/0.141
CM-GM-1	Counter nut for 1" thread	1SVR 450 056 R 8000	1	0.010/0.247

### Bar Electrodes

#### Description

Thread M4 for use with KH-3 probe holder  
 Material: stainless steel 304, high-grade steel 14301

Length mm	Part Number	Pack. unit (pieces)	Weight 1 pc. kg/oz
300	1SVR 450 056 R 0000	1	0.030/1.058
600	1SVR 450 056 R 0100	1	0.060/2.116
1000	1SVR 450 056 R 0200	1	0.100/3.527

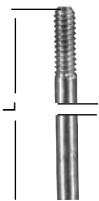

LLC02B01 09.07.04